



The All-in-One Contactless, Chip and Swipe Card Reader

Go here. Go there. Accept payments anywhere. Clover® Go Contactless Reader is your go-to point-of-sale device for credit card swipes, dips, and taps. Just bring your smartphone or tablet and a free hand.



Fast

No matter how your customer is paying, contactless, EMV® chip, or traditional swipe, Clover Go can take it – and get you paid fast.



Smart

Big things come in small packages. With Clover Go, you get sales reporting, business insights, and more.

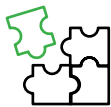

Flexible

The Clover platform provides a variety of hardware and software solutions that grow with you as your business evolves.



Less to worry about with Clover in your corner:

Data Protection – Clover Security can help protect your business and customers.

24/7 Support – Get help when you need it. Our knowledgeable support team is available to address your questions or issues whenever they arise.

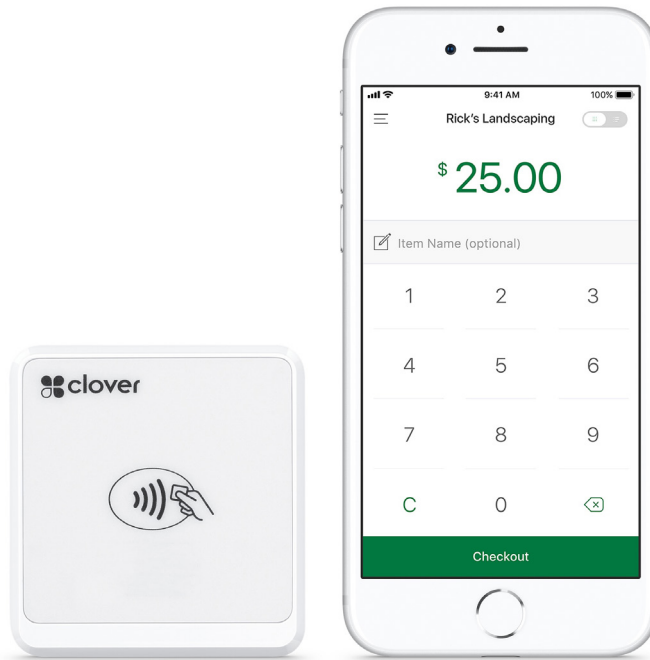

Tap. Dip. Swipe. Repeat. All day. Every day.

Whether you're running around town or running around your store, the Clover Go mobile point-of-sale device and the Clover Dashboard management portal place additional features at your fingertips.

Connect Wirelessly

The Clover Go pairs seamlessly with your mobile device or tablet through a Bluetooth® connection.

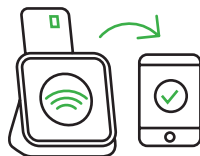

Tips & Taxes

Set custom percentage amounts for tips and create multiple tax rates for the things you sell.



Paperless Receipts

Customers want it their way, right down to the receipt. With Clover Go, it's simple to email or text receipts to your customers to keep them happy.



End-to-End Security Software

Built-in Clover Security can help protect your customers, business, and reputation from fraud.



First Data

For more information, please contact your CBE